

**68.104. Accessible Parking Spaces**

68.104. Accessible Parking Spaces.  
(New section effective August 1, 2020, 45 TexReg 5166)

- (a). A paved accessible parking space must include:
  - (1). the International Symbol of Accessibility painted conspicuously on the surface in a color that contrasts the pavement;
  - (2). the words "NO PARKING" painted on any access aisle adjacent to the parking space. The words must be painted:
    - (A). in all capital letters;
    - (B). with a letter height of at least twelve inches, and a stroke width of at least two inches; and
    - (C). centered within each access aisle adjacent to the parking space; and
  - (3). a sign identifying the consequences of parking illegally in a paved accessible parking space. The sign must:
    - (A). at a minimum state "Violators Subject to Fine and Towing" in a letter height of at least one inch;
    - (B). be mounted on a pole, post, wall or freestanding board;
    - (C). be no more than eight inches below a sign required by Texas Accessibility Standards, 502.6; and
    - (D). be installed so that the bottom edge of the sign is no lower than 48 inches and no higher than 80 inches above ground level.
- (b). A parking space identification sign that complies with Texas Accessibility Standards, 502.6, that includes the requirements in subsection (a)(3)(A) satisfies subsection (a)(3).

**ARRIS**  
consulting

1910 Research Blvd. Bldg 1      Lubbock, Texas  
806-773-6763



10-13-2022

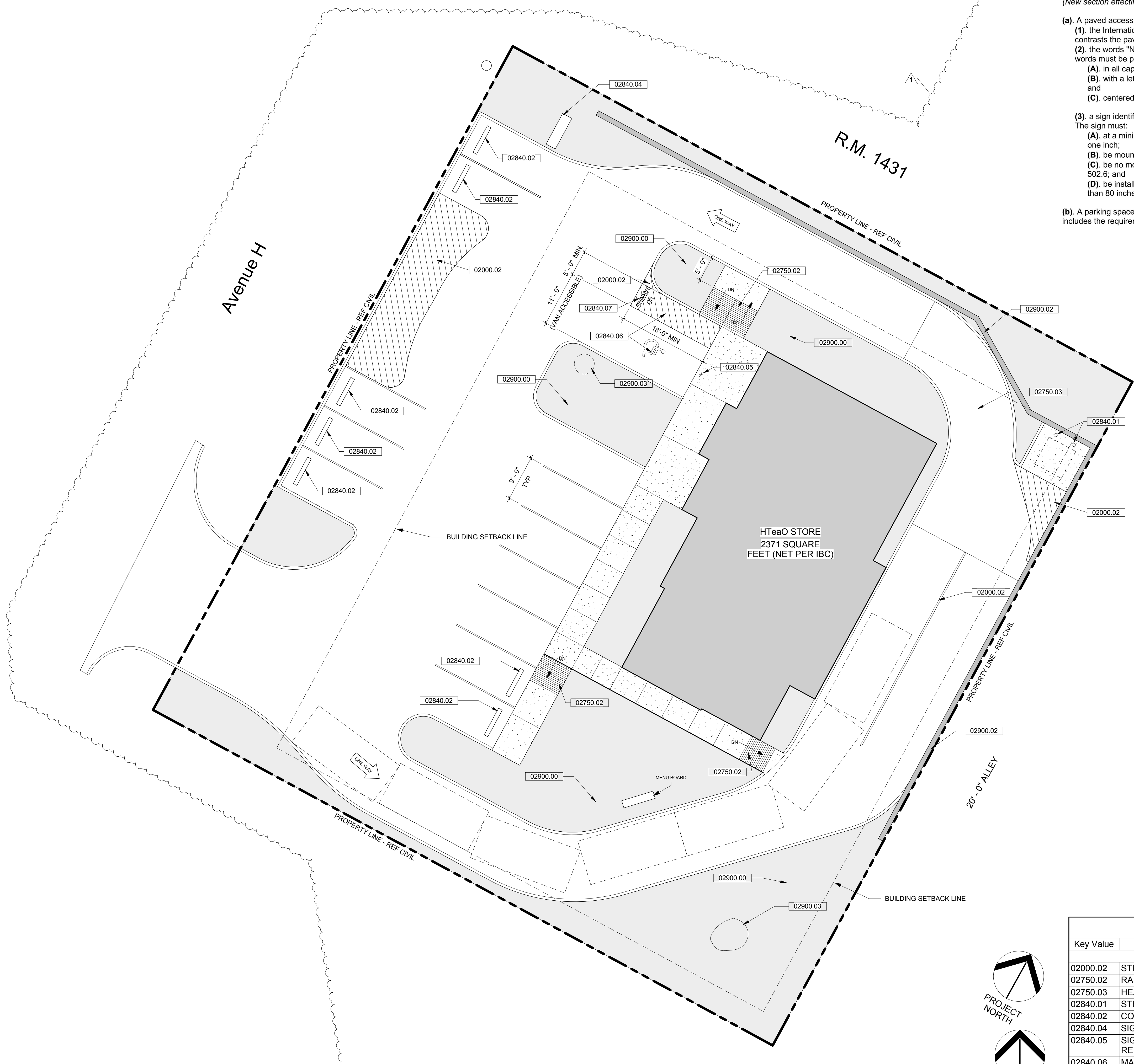

**Site Data**

Lot Area: 0.482 Acres  
20,995 Sq Ft

Building Area: 2371 Sq. Ft. to Inside Face of Perimeter Wall (Per IBC)  
2479 Sq. Ft. to Outside Stud Line

- Notes:**
- THIS SITE PLAN IS PROVIDED FOR GENERAL INFORMATION PURPOSES ONLY AND IS NOT INTENDED TO SUPERSEDE THE REQUIREMENTS OF CIVIL ENGINEERING DOCUMENTS PREPARED BY OTHERS.  
SHOULD DISCREPANCIES BE FOUND BETWEEN THIS PLAN AND CIVIL DRAWINGS, CIVIL DRAWINGS SHALL TAKE PRECEDENCE. PLEASE NOTIFY ARCHITECT IMMEDIATELY IF SUBSTANTIAL DISCREPANCIES ARE IDENTIFIED.
  - REFER TO CIVIL DRAWINGS PREPARED BY OTHERS FOR DIMENSIONAL CONTROL, GRADING, SITE UTILITIES, PAVING AND OTHER ASSOCIATED WORK.  
REFER TO CIVIL DRAWING SHEET 7 FOR TABLE WITH SUMMARY OF EXISTING AND PROPOSED PERVIOUS AND IMPERVIOUS AREAS.
  - REFER TO ELECTRICAL SHEET E-100 FOR SITE ELECTRICAL WORK.
  - ACCESSIBLE PARKING SPACE AND AISLE MARKING SHALL CONFORM TO THE REVISED REQUIREMENTS OF TAS PARAGRAPH 68.104 ON THIS SHEET.

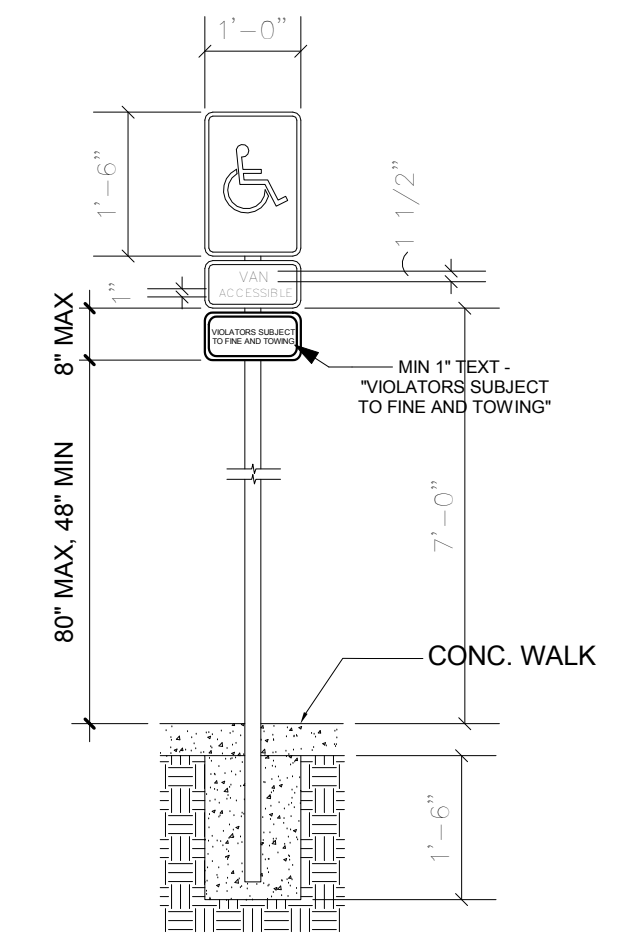

ACC. PARKING SIGN  
2 Accessible Parking Signage  
A-101.4 1/2" = 1'-0"

Key Value	Keynote Text
02000.02	STRIPING PER CITY OF MARBLE FALLS STANDARD
02750.02	RAMP TO T.A.S. STANDARD - REF CIVIL FOR SLOPE
02750.03	HEAVY DUTY CONCRETE PAVING - REF CIVIL FOR PAVING SPECS
02840.01	STEEL BOLLARD - REF DETAIL
02840.02	CONCRETE PARKING BLOCK
02840.04	SIGN BY OWNER - PROVIDE POWER AND DATA IF REQUIRED
02840.05	SIGN FOR VAN ACCESSIBLE SPACE PER TAS 2012 SECTION 68.104. REF DETAIL THIS SHEET
02840.06	MARKING AND SIGNAGE FOR ACCESSIBLE SPACE SHALL MEET REQUIREMENTS OF TAS 2012 SECTION 68.104 - ADDED AUG. 1 2020
02840.07	12" HIGH BLOCK LETTERING "NO PARKING"
02900.00	LANDSCAPE AREA
02900.02	RETAINING WALL - REF CIVIL
02900.03	EXISTING TREE TO REMAIN

1 Site Plan  
A-101.4 1" = 10'-0"

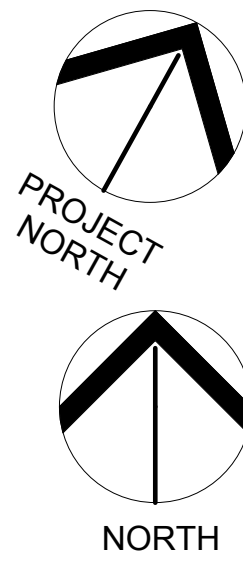

909 Avenue H  
Marble Falls, Texas 78654

**Architectural Site Plan**

Project Number: \_\_\_\_\_  
Initial Sealed Release Date: \_\_\_\_\_ 08-16-2021

CITY OF  
*Marble Falls*  
TEXAS

A-101.4

Development Services Department  
All construction shall meet the adopted codes and ordinances of the City of Marble Falls and all applicable state and federal laws. Any deviations from this set of plans must be approved by the City of Marble Falls.

Approved Reviewer: *Mike Ingalls*

10/13/2022 9:18:55 AM